

PRODUCED BY AN AUTODESK EDUCATIONAL PRODUCT
 PROPOSED RESIDENTIAL HOUSE FOR I.H.S.D.P. SCHEME AT
 SEC. NO. 17 IN SOUTH EXTENSION SCHEME, UDAIPUR.

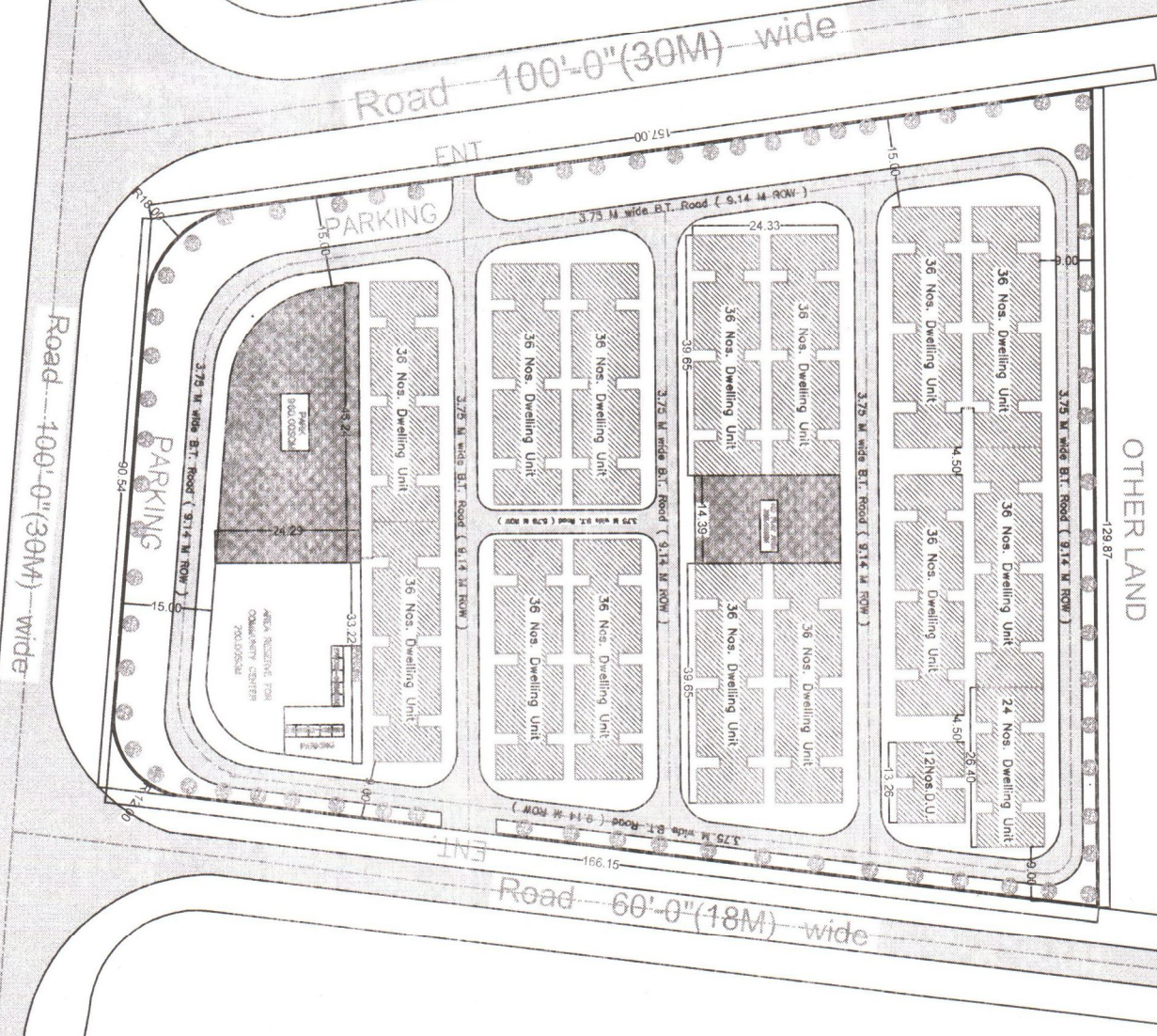

OTHER LAND

Road 100'-0" (30M) wide

Road 60'-0" (18M) wide

PRODUCED BY AN AUTODESK EDUCATIONAL PRODUCT

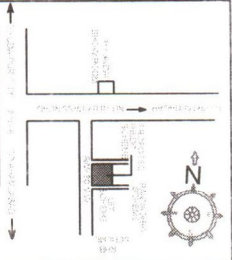

TOTAL AREA OF SITE: 1754 SQ.M.
 TOTAL AREA OF BUILT UP AREA: 12500 SQ.M.
 TOTAL COVERED AREA: 12500 SQ.M.
 TOTAL OPEN AREA: 504 SQ.M.
 TOTAL NO. OF DWELLING UNITS: 120
 TOTAL NO. OF FLOORS: 1
 TOTAL NO. OF PARKING SPACES: 120
 TOTAL NO. OF COMMUNITY CENTERS: 1
 TOTAL NO. OF PLAY AREAS: 1
 TOTAL NO. OF OPEN AREAS: 1

LEGENDS:
 Parking area
 ROAD
 PARK

SCALE = 1:400
 DRAWING TITLE:-
 PROPOSED RESIDENTIAL HOUSE
 FOR I.H.S.D.P. SCHEME AT SEC.17
 IN SOUTH EXTENSION SCHEME,
 UDAIPUR.
 SUBMITTED BY:-
 TELECOMMUNICATION CONSULTANT
 INDIA LTD. NEW DELHI (INDIA)
 ARCHITECT / CONSULTANT:-